

NOTES

ALL PLANTS SHALL MEET MINIMUM STANDARDS OUTLINED IN THE AMERICAN STANDARDS FOR NURSERY STOCK, (LATEST EDITION) PUBLISHED BY THE AMERICAN ASSOCIATION OF NURSERYMEN, INC.

PLANTS SHALL BE SOUND, HEALTHY AND VIGOROUS, BE WELL BRANCHED AND DENSELY FOLIATED WHEN IN LEAF. PLANTS SHALL BE FREE OF DISEASE, PESTS, EGGS/LARVAE AND THEY SHALL BE FREE OF DAMAGE. DAMAGE INCLUDES, BUT IS NOT LIMITED TO SCRAPES ON THE BARK OR EVIDENCE OF GIRDLING FROM WIRE OR OTHER STAKING/BINDING MATERIAL.

CONTAINER PLANTS SHALL BE FREE OF SEVERE ROOT BOUND CONDITIONS. CONTRACTOR TO LIGHTLY SCARIFY/LOOSEN OUTER ROOTS AT TIME OF PLANTING.

ALL PLANTS SHALL BE PURCHASED FROM BONA-FIDE WHOLESALE NURSERIES AND/OR GROWERS.

PLANTS SHALL BE COVERED BY TARP OR WITHIN ENCLOSED TRUCK DURING TRANSPORT TO SITE.

SUBSTITUTIONS SHALL BE APPROVED BY THE OWNER OR THEIR DESIGNATED REPRESENTATIVE.

DESIGNATED MULCH AREAS TO BE MULCHED WITH A 4" DEPTH OF CLEAN, UN-DYED, TRIPLE SHREDDED HARDWOOD MULCH.

PLANT QUANTITIES SHOWN IN PLANTING LIST IS FOR CONTRACTOR CONVENIENCE ONLY. IT IS THE CONTRACTORS RESPONSIBILITY TO OBTAIN QUANTITIES BASED ON PLANTS SHOWN ON THE DRAWINGS.

ANY EXISTING TREES AND PHYSICAL IMPROVEMENTS ARE SHOWN FOR REFERENCE ONLY. ADDITIONAL TREES/IMPROVEMENTS NOT SHOWN MAY EXIST ON SITE.

ALL PLANTS TO RECEIVE A SOIL ADDITIVE AT TIME OF PLANTING. SOIL ADDITIVE SHALL CONSIST OF ONE PART TOPSOIL TO ONE PART SAND. BOTH SAND AND TOPSOIL SHALL BE FREE OF ROOT, ROCKS OR OTHER MATERIAL AND SHALL BE THOROUGHLY MIXED PRIOR TO PLANTING.

ALL PLANTS TO BE LIGHTLY TAMPED AFTER PLANTING TO ELIMINATE AIR POCKETS AND TO FIRMLY STABILIZE PLANTING.

ALL MULCHED LANDSCAPE BEDS TO BE BORDERED BY A TRENCHED EDGE.

ALL LANDSCAPED BEDS TO RECEIVE A 1 FOOT DEPTH OF CLEAN SAND PRIOR TO PLANTING.

CONTRACTOR TO WARRANTY PLANTS FOR ONE YEAR.

CONTRACTOR TO LOCATE ALL UTILITY SERVICE LINES (INCLUDING WATER) THAT SERVICE BUILDINGS PRIOR TO DEMOLITION/PLANTING.

LEGEND AND PLANT LIST

QTY.	COMMON NAME	BOTANICAL NAME	SIZE/ COND.	SPACING	REMARKS
13	Crape Myrtle	Lagerstroemia indica	15 Gal. 5-6' Ht.	50' O.C.	Tuscarora variety
34	Pink Muhly Grass	Muhlenbergia capilaris	3 Gal. Cont.	3' O.C.	Full/Well Branched
18	Sweet Drift Rose	Rosa 'meiswestdom'	3 Gal. Cont.	4' O.C.	Pink Flowers
73	Dianthus	Perennial Dianthus	1 Gal. Cont.	2' O.C.	Full/Well Branched

Crape Myrtles to be Tuscarora or Sioux variety. Use same variety for each area.
Any substitutions to be approved by owner.
NOTE:
ALL TREES TO BE PLANTED A MINIMUM OF 12' FROM THE EDGE OF PAVEMENT OF OCEAN TRAIL

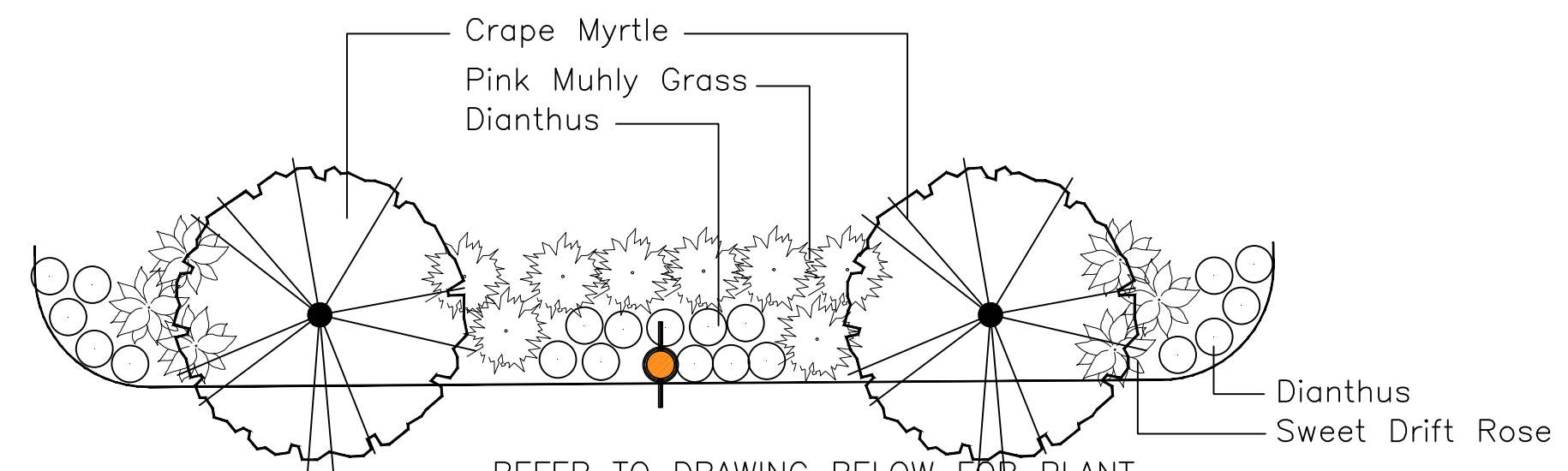

TYPICAL LANDSCAPE ISLAND
NOT TO SCALE

SUN REALTY

- Lscape Bed F**
2 Crape Myrtle
8 Pink Muhly Grass
6 Drift Rose
20 Dianthus

- Lscape Bed E**
2 Crape Myrtle
6 Pink Muhly Grass
6 Drift Rose
20 Dianthus

- Lscape Bed D**
3 Crape Myrtle
20 Pink Muhly Grass
6 Drift Rose
33 Dianthus

COUNTY OFFICES

Center bed on County Office Building. Locate trees 24' from edge of road.

Crape Myrtles on East Side of Ocean Trail to be Planted 26' From Edge of Pavement

OCEAN TRAIL
100' R/W

Potential Expanded Landscape Bed
Existing Landscape Bed

Crape Myrtles on West Side of Ocean Trail to be Planted 5' From West Edge of Walkway. Plant Crape Myrtles Only on West Side of Ocean Trail.

WINKS

WILD HORSE TOURS
BEER GARDEN

TWIDDY

OLD LIFE
SAVING STATION

County Office

ISSUED FOR BID

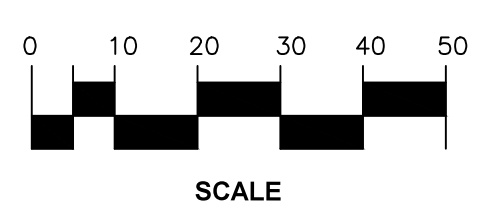

LAUGHING GULL DESIGN STUDIO
LANDSCAPE ARCHITECTURE • LANDPLANNING • ENVIRONMENTAL CONSULTING
KITTY HAWK, NORTH CAROLINA 27949
PHONE (252) 261-8747

Greenspace
Landscape Planning & Design
Nags Head, NC 27959
252-673-9346



Know what's below.
Call before you dig.



Corolla Beautification Project
Currituck County, North Carolina

October 1, 2017
rev. 10/20/17, 10/27/17 **DWG CBP 7**